

Phase 4
5/2/19 - substantial completion

Temporary
Dumpster &
Recycling
Location.
Construction
temp wood ramp
here.

24'-0" Sliding
Construction
Gate

2 each 10'-0"
Construction
Gates

16'-0"
Construction
Gate

General Notes:
- This sheet is for construction fencing and construction laydown purposes only
- Cannot block traffic on Jefferson
- Must have traffic control when entering and existing site
- Must maintain access to and from parking lot and Monroe drive at all times.
- East fence line shall be free standing fence panels. Contractor shall drive post on every other panel.

Construction
Parking

Maintain access to drive

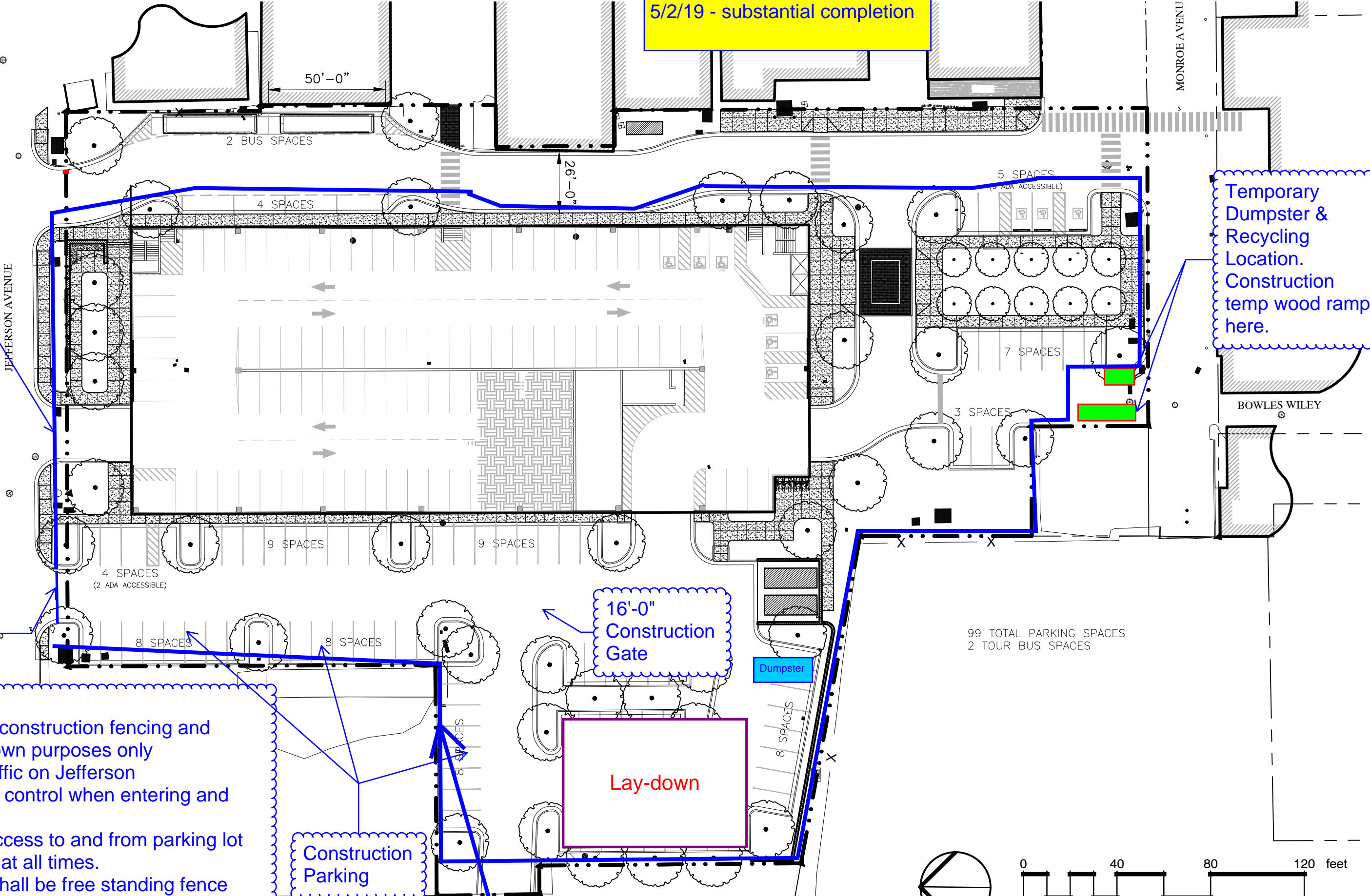

99 TOTAL PARKING SPACES
2 TOUR BUS SPACES

